

# Safeco Plaza

1001 FOURTH AVENUE

## SUITE 3200

19,795 SF • FULL FLOOR • AVAILABLE NOW

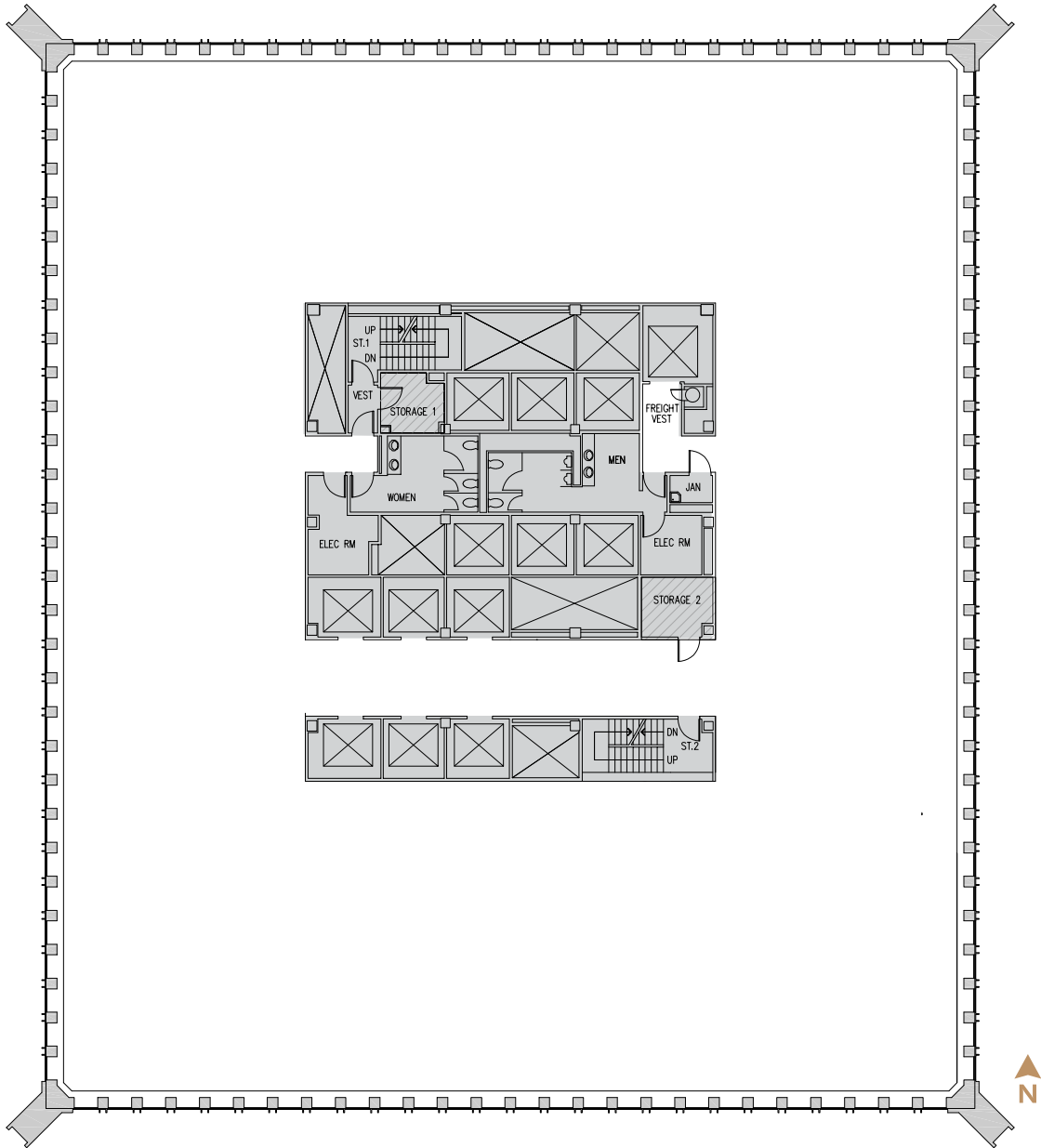

GREG INGLIN EXECUTIVE VICE PRESIDENT | +1 206 292 6128 | GREG.INGLIN@CBRE.COM

TIM OWENS SENIOR VICE PRESIDENT | +1 425 462 6913 | TIM.OWENS@CBRE.COM

