

# Safeco Plaza

1001 FOURTH AVENUE

## SUITE 4200

20,325 SF • FULL FLOOR • AVAILABLE JANUARY 1, 2024

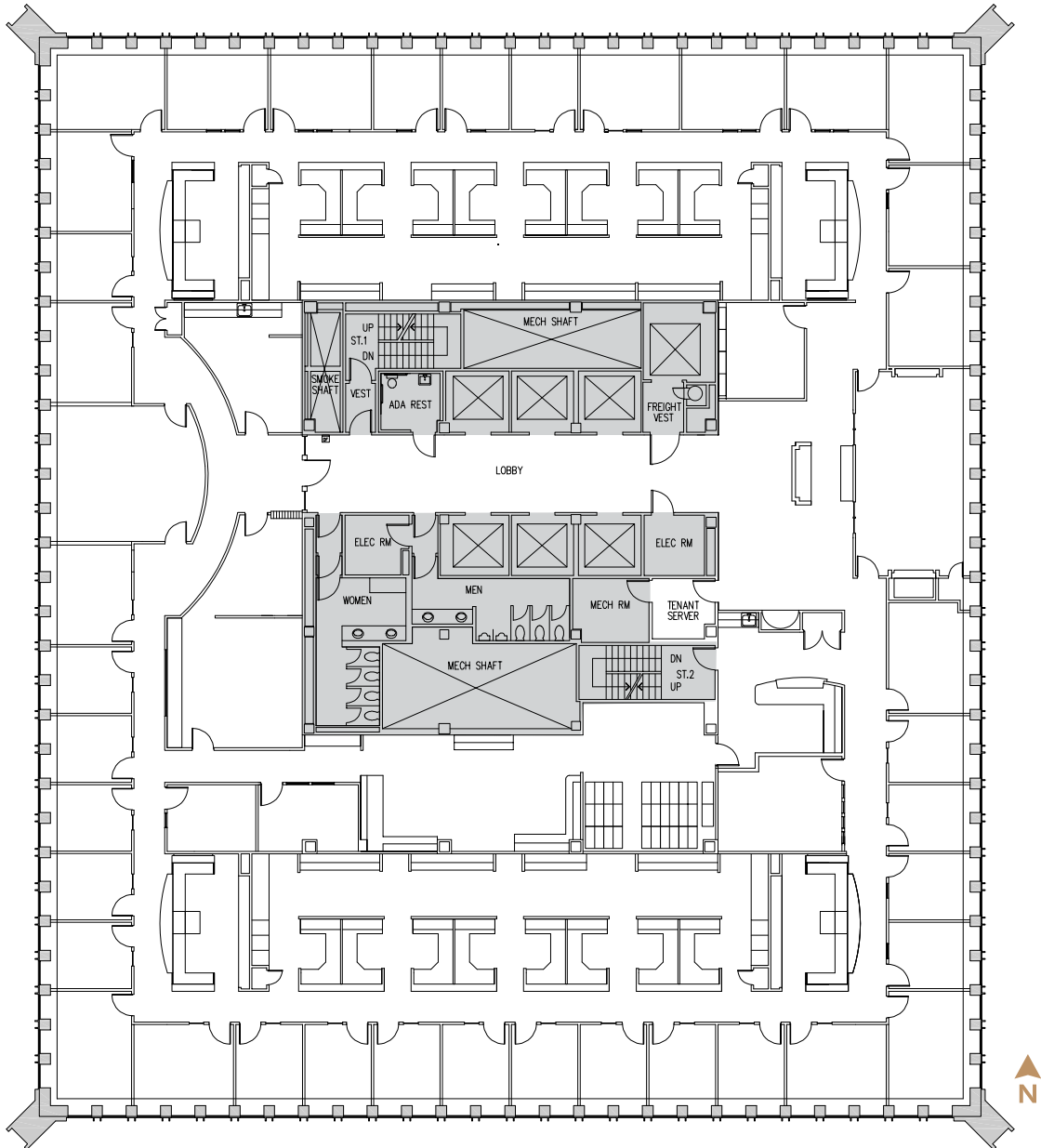

GREG INGLIN EXECUTIVE VICE PRESIDENT | +1 206 292 6128 | GREG.INGLIN@CBRE.COM

TIM OWENS SENIOR VICE PRESIDENT | +1 425 462 6913 | TIM.OWENS@CBRE.COM



© 2023 CBRE, Inc. All rights reserved. This information has been obtained from sources believed reliable, but has not been verified for accuracy or completeness. You should conduct a careful, independent investigation of the property and verify all information. Any reliance on this information is solely at your own risk. CBRE and the CBRE logo are service marks of CBRE, Inc. All other marks displayed on this document are the property of their respective owners. Photos herein are the property of their respective owners. Use of these images without the express written consent of the owner is prohibited. PM\_April2023